

SeaMatic 808

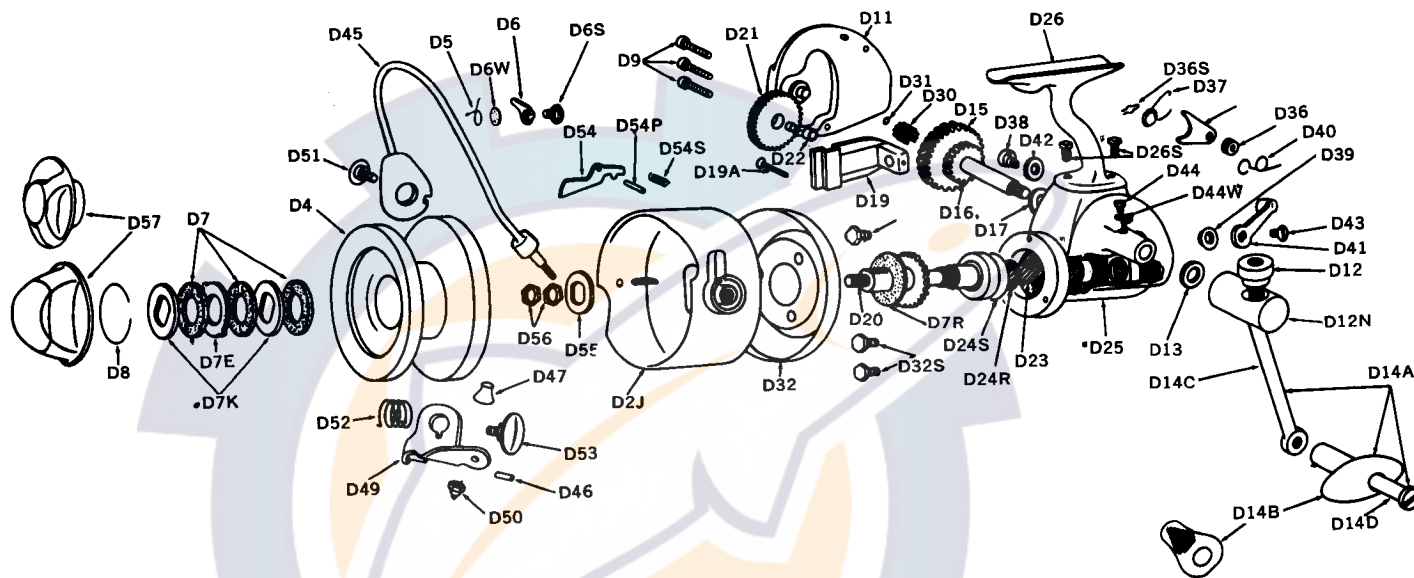
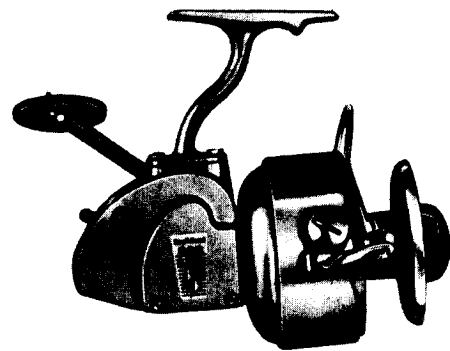

PARTS BREAKDOWN FOR THE SeaMatic REELS

| Part Name | Part No. | Price | Part Name | Part No. | Price | | |
|---|----------|-------------------------|-----------|----------------------------------|-------|----------|------|
| Pickup Housing Assembly | D2J | DA4742TV | \$5.00 | Frame Assembly | D25 | DA4704TV | 7.75 |
| Spool Assembly (Includes Clutch Washers) | D4 | DA4778TV | 6.00 | Rod Clip | D26 | DA4705TV | 1.45 |
| Click Spring | D5 | E4847 | .05 | Rod Clip Screw | D26S | E4828 | .15 |
| Click Pawl | D6 | E780 | .10 | Level Wind Pinion | D30 | E854 | .50 |
| Click Screw | D6S | E5015 | .15 | Level Wind Pinion Ret. Ring | D31 | P896 | .02 |
| Lock Washer | D6W | E5078 | .05 | Bearing Cover | D32 | A4711TV | .75 |
| Drag Washer Leather | D7 | L2155 | .15 | Bearing Cover Screw | D32S | E4712 | .10 |
| Drag Eared Washer | D7E | B2154K | .15 | Bail Trip Screw | D33 | E4713 | .35 |
| Drag Keyed Washer | D7K | B3952K | .15 | Non-Reverse Pawl | D34 | E4796 | .25 |
| Drag Washer, Rear | D7R | L4824 | .15 | Non-Reverse Spring Washer | D36 | E4891 | .10 |
| Clutch Retaining Spring | D8 | E4775 | .03 | Retainer Spring | D36S | E4475 | .02 |
| Cover Screw | D9 | B4728K | .05 | Non-Reverse Pawl Spring | D37 | E4716 | .05 |
| Cover Assembly, opposite crank | D11 | Order by Reel Name, No. | 2.10 | Non-Reverse Pawl Throwout | D38 | E4717 | .45 |
| Crank Locking Nut | D12 | A4733GJ | .30 | Non-Reverse Throwout Bushing | D39 | N4823 | .25 |
| Crank Mounting Nut | D12N | A4734GJ | 1.00 | Throwout Tension Spring | D40 | E4814 | .10 |
| Crank Mounting Nut | D13 | E4736 | .05 | Throwout Lever Assembly | D41 | B4798K | .60 |
| Thrust Washer | | | | Throwout Washer | D42 | B4817 | .05 |
| Crank Assembly | D14A | A4732GJ | 2.95 | Throwout Lever Screw | D43 | B1493K | .10 |
| Crank Handle | D148 | JK4802 | .60 | Oiling Screw | D44 | B4720K | .20 |
| Crank Shaft | D14C | A4727GJ | 1.90 | Oiling Screw Washer | D44N | R4799 | .15 |
| Handle Stud | D14D | A4731NJ | .35 | Bail Wire Assembly | D45 | NE5626 | 3.45 |
| Drive Gear Assembly | D15 | E4724 | 3.15 | Bail Stop | D46 | R4906 | .10 |
| Non-Reverse Ratchet | D16 | E4816 | .55 | Line Roller | D47 | CY4903 | 1.75 |
| Drive Gear Thrust Washer | D17 | E4726 | .05 | Roller Mounting Bracket Assembly | D49 | B5348K | 1.25 |
| Level Wind Yoke | D19 | DA4761 | 1.25 | Roller Lock Nut | D50 | B4750N | .25 |
| Level Wind Yoke Screw | D19A | E4762 | .20 | Bail Trip Bracket Screw | D51 | B4899K | .35 |
| Main Shaft Assembly | D20 | E4759 | 1.90 | Bail Torsion Spring | D52 | E5345 | .20 |
| Level Wind Gear Assembly | D21 | A4765 | .95 | Roller Mounting Bracket Screw | D53 | B5346K | .50 |
| Level Wind Roller | D22 | E4766 | .15 | Bail Trip Lever | D54 | *E4739K | .05 |
| Helical Pinion and BB Assembly | D23 | E4879 | 4.35 | Bail Trip Lever Pin | D54P | *E4740 | .03 |
| Helical Pinion Assembly | D23A | **E4709 | 2.00 | Bail Trip Lever Spring | D54S | E4741 | .10 |
| Pinion Ball Bearing | D24 | **E4710 | 2.35 | Pickup Housing Lock Washer | D55 | E4754 | .25 |
| Bearing Shield Ring | D24R | R5308 | .15 | Pickup Housing Nut | D56 | E4755 | .25 |
| Bearing Shield | D24S | TF5229 | .10 | Drag Adjusting Nut Assembly | D57 | JK4782 | 1.45 |

DISASSEMBLY and ASSEMBLY INSTRUCTIONS

1. Unscrew the drag adjusting nut (D57) from the main shaft (D20), then slide spool (D4) off the main shaft. 2. Next, put non-reverse lever (D41) into the forward "ON" position. Remove crank (D14A) by unloosening it with a backward turn and unthreading. Loosen crank locking nut (D12) from crank shaft. Now, your SeaMatic is ready for washing. 3. Using fresh water and brush, scrub exposed parts thoroughly. Be sure to scrub the bail (D45) where it connects to the pickup housing (D2J). When reel has been washed free of salt, dry

all parts carefully with a soft cloth. 4. With reel completely dry, you're ready to begin the lubrication of your reel. Remove oiling screw (D44). Using a light reel oil and grease, following diagram above, oil all parts marked by letter "O" and grease all parts marked by letter "G". Now, replace crank thrust washer, (D13) . . . followed by crank and oil screw. 5. Replace spool (D4) on main shaft (D20) with a rotating movement until it is properly seated. Then replace the drag adjusting nut. Turn crank to see if assembled reel operates properly.

Numbers shown in red common to both South Bend and Shakespeare.

NOTE: When ordering parts, give reel part name, reel number and model.